

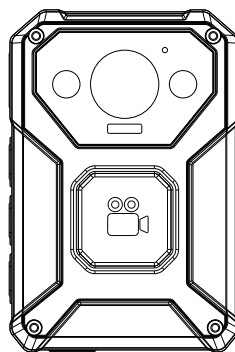

S7 Body Camera



USER MANUAL

Catalogue

Specification	01
Charge	02
Diagram	03
Quickstart	05
Software	06
FAQ	07

Specification >>>

4G body camera is a live streaming and video recording system. It is typically utilized by police officer to record their mission. Camera features 2K resolution, 16 hours recording, night vision, 4G/WiFi/bluetooth and GPS. Also, camera support data protection to prevent unauthorized access via USB.

RECORDING	
Video Resolution	1440P(30FPS)/1296P(30 FPS)/ 1080P(30 FPS)/ 720P(30 FPS)/ 480P(30 FPS)
Video Format	MP4 with H.264/ H.265
Live Video Resolution	720P
Recording Angle	Wide Angle 140 degrees
Audio	High Quality Built-in Microphone.
Water Mark	User ID, Time and date Stamp Embedded into Video.
Record Button	Front Big Button
Other Button	PTT Button, SOS Button, Audio Button, Photo Button, Power Button, IR Button, Left +Right +Confirm + Back Button
Video Duration	10 mins, 20 mins, 30 mins
Recording Time	Above 15 hours at 1080P (4G&WiFi off)
Pre-Record/Post Record	Support
Activation prompt	Vibrator & Speaker & LED Indicators
PHOTOGRAPH	
Camera Format	JPEG
Snap Shot	Capture Photos During Video Recording
Photo Resolution	32 Megapixels JPEG
BATTERY	
Type	Built-in 4400mah battery
Charging Time	300 minutes
Wireless	
WiFi	2.4GHz
Bluetooth	Optional BLE 4.0
4G Band	LTE-FDD:B1/B3/B5/B7/B8/B20 LTE-TDD:B38/B40/B41
NFC	Optional / Support to Write ID or Settings via NFC
OTHERS	
Display	High resolution 2inch LCD
Storage Capacity	32G/64G/128G/256GB
IR Light	2PCS 850nm Large Infrared LED
Auto IR Control	Support
White LED	Support
SOS LED	Red and Blue LED
Speaker	Waterproof and High-power Speaker
Waterproof	IP68 (Up to IP67)
Clip	High Quality Metal Clip with 360° Rotation
Magnetic Connector	Support
Audio -in/out	Support 3.5mm Earphone
Password Protection	Requires Password to Access to Video
Dimensions	83*55*29mm
Weight	155 Grams
Working Temperature	-20C° ~ 65C°
Storage temperature	-20C° ~ 65C°
Video Encryption	Support AES256
GPS	GPS
4G Software Platform	CMSV (Real Time Monitoring/ SOS/ GPS Tracking/ Intercom)
ACCESSORIES	
Standard Accessories	Magnetic USB cable, Charger, Single Dock, Crocodile Clip, Manual
Other Accessories	Magnet Mount, Lock Clip, Car Mount, Harness, Earphone

*Above specification are for reference, and it subjects to actual product

Charge >>>

Charging and Download

First time to use the camera, please keep it charging for at least 4 hours.

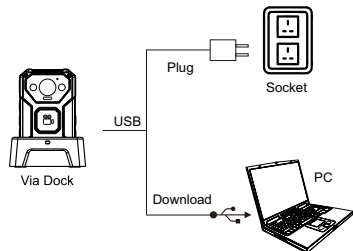
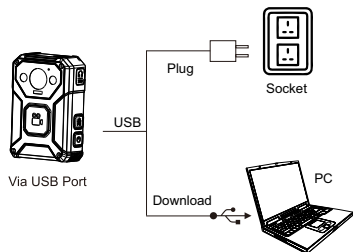

Before connect camera to USB, make sure the power voltage is not more than 5.5V. Otherwise, it will do harm to battery and burn the camera. Please use our standard charger and cord.





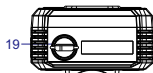
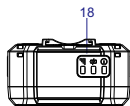
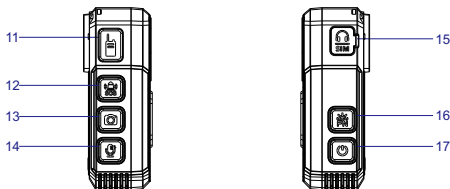
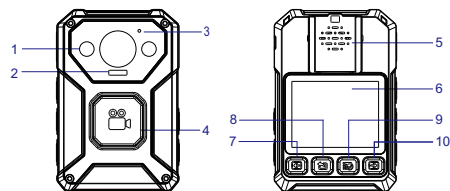

Sometimes computers can not afford enough power, therefore it can not recognize the camera. Please change to other USB3.0 port if necessary.

Diagram >>>



- 1. 850nm Infrared x 2
- 2. SOS LED & White LED
- 3. Microphone
- 4. Record Button/NFC(Optional)
- 5. Speaker
- 6. LCD Screen
- 7. Left Button
- 8. Return Button /Lock function
- 9. Menu /Confirm Button
- 10. Right Button
- 11. PTT Button
- 12. SOS Button
- 13. Photo Button
- 14. Audio Button
- 15. Audio Out/In & Sim Card Slot
- 16. IR / White LED Button
- 17. Power Button
- 18. Power LED/ Charging LED/ Platform LED
- 19. Magnet Mount / Type C

Diagram >>>

No.	Item	Functions
1	Infrared LED	In the night vision, IR LED helps to get a clear black and white videos. It gets activated automatically when low LUX
3	Microphone	To capture audio from dual microphones, please clean it frequently in case dust influence the mic.
*4	Record Button	Press to start video recording, then press again to stop recording. Press and hold to send SOS to platform
*4	Optional NFC	It helps to input User ID or other settings to cameras via NFC card reader.
7	Left Button	During standby mode, hold it to zoom out. When playback, press left to rewind. In other situations, it is for up and left.
*10	Right Button	During standby mode, hold it to zoom in. When playback, press right to fast forward. Under standby mode, press to enter playback. In other situations, it is for down and right.
11	PTT Button	When connected to CMSV, user can press or hold PTT button to communicate with backend system.
15	Audio/USB Port	Mini USB connector support quick charging up to 5V2A. Support optional dedicated earphone
*15	Nano SIM Card	Camera Support Standard Nano SIM Card/ Please insert SIM card in this direction 
*17	Power Button	Press and hold to turn on/off device. During Standby, press to turn off LCD display. Hold 10 seconds+ to reboot the camera.
18	Power LED  	Green - Standby Mode Red - Video Recording(Constant), Pre-record(Blinking)
18	Charging LED  	Blue - Charging Yellow - Receiving GPS(Blinking), Received (Constant)
*18	Platform LED 	White - CMSV Connected (Constant) White - CMSV Connecting (Blinking)
20	Type C	This USB-C connector can support a maget connector.

Note: Please pay attention to the items with " * " .

Quickstart >>>

1) Power On:

Press and hold the "Power" button for about 3 seconds, the unit will emit ONE audio sound and long vibration. A green indicator on top of the unit will turn on and remain green while the unit is powered on.

2-1) Video Recording:

To record a video, press the "Recording Button" located on the front of device. The unit will emit 1 audio chirps and 1 vibration. A red working indicator on the top of the unit will turn on and remain red until recording is ended. Press "recording button" again to stop recording.

(The unit won't give any feedback if you stop recording video in 3 seconds.)

Start Recording Stop Recording Mark Video



2-2) SOS:

When camera connected to 4G platform, user can press and hold SOS button to activate SOS alarm. Then backend software will pop up message and show live streaming video as well as location info.

3-1) Taking Photo:

To take a photo, press the "Photo" button. The unit will emit 1 audio sound and vibration.

3-2) Push to Talk

The unit can talk to backend software after connected to network. To press and hold photo button, then user can speak to command center. After release photo button, user can hear voice from center.



4) LED Display

Users can press "Power Button" to turn on/off display. During preview mode, some basic information are listed on the screen. Then click "Menu Button" to enter setting page, or click "Return Button" to enter playback page.

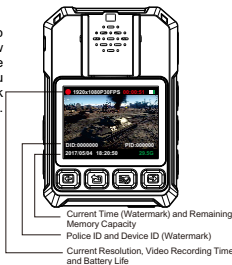

5) How to Reset?

If you are having problems with your device, please try and reset the camera using the reset button. It won't erase any data or settings.

6) GPS function (Optional)

GPS signals are available in open area. (outside of building). And wait at least 1-5 mins for satellite searching.

Software >>>

Find Cammanager.exe in the CD disc, double click to open it. This software is for configuring camera and access to memory. It does not require extra driver.



How to Login?

1. Connect Camera to PC.
2. Input your password, then click "Connect Device".
Default Password is 000000 (six zero).

Time Setting

After login the cammanager, click "Sync Date and Time" button. To Synchronize PC Time.

Recording Parameters

- 1) Select recording video resolution (from 480P to 1440P),
- 2) Select the length of each video (from 10 to 30 Mins),
- 3) Select video quality from low to high.

Access to Data

After login the cammanager, click "Unlock Memory Card" button.

Failure	Diagnose	Solution
Can not Power On	No Power	Charge camera for at least 3 hours.
	Protection Mode	Press Reset button, and restart camera
	Stealth Mode	Camera has been powered on, but it is in stealth mode. press and hold photo button to recover.
Short Working Time	Battery Power is not enough	1. First time or did not use for a long time, please discharge the camera, then charge it for at least 3 hours before use it. 2. Do NOT charge camera when it is too hot /cold.
Data Transfer is not stable	Power of USB is not enough to afford charging and download	1. Use other USB port on your laptop 2. Use the dock station 3. Delete the corrupted videos or data if existed.
Computer can not recognize the device	USB Cable	Change the USB cord
	Forget Password	Contact your seller to reset password
No WiFi connection	Device is unable to connect WiFi Hotspot	1. Please check the WiFi SSID and PW again via cam manager. Some special symbols and empty space are not allowed. 2. Restart camera and put it closed to WiFi router.
No 4G connection	Device is unable to connect 4G Network	1. Please check the direction of inserted SIM card. 2. Input the APN/User Name/PW if necessary. 3. If the 4G LTE band is not supported, please try to use another SIM from other service provider.
Device is offline in CMSV	Device is unable to connect server software.	1. Check the IP address of server, and try to ping it via computer. 2. Be sure the device ID is bind with the account in server software
Fail to start recording	Memory is full	Delete videos data via cam manager tool.
	System crash	Restart camera by reset button
No audio during intercom	Mic or speaker is disable	1. Turn on the mic and speaker of computer. 2. Push photo button before talking (PTT mode)

Product Warranty Card

Customer Information	Name:	
	Address:	Zip Code:
	Tel:	
Product Information	Model Name:	
	Serial No.:	
	Purchase Date:	
Failure Detail		

